

# Horizon 6910 LIVING QUARTERS

The Horizon 6910 Living Quarter boasts the industry leading characteristics that are expected in a Sundowner Trailer including all aluminum construction, full bathroom and an array of standard features for the comfort and safety of owners and horses. The 6910 is available in 2 to 8 horse models. The Living Quarter features an air conditioner, furnace, microwave, 2 burner cook top, am/fm cd player, sofa, walk-in closet and a separate toilet and shower.

## INTERIOR STANDARD EQUIPMENT

- 15,000 BTU a/c with heat strip
- Wallboard walls and ceiling
- Wood window frames
- Raised panel cabinet doors
- Overhead cabinets above sofa and kitchen area
- 8 Cu. ft 12v electric refrigerator
- 2 Burner cook top with cover, range hood and exhaust fan
- Microwave
- Formica counter tops
- Single bowl kitchen sink
- TV Antenna
- AM/FM radio, CD player with interior and exterior speakers
- Jack knife sofa
- Day/night shades
- Color coordinated valances
- Choice of vinyl flooring with carpeted bedroom
- Mattress
- Quilt
- TV Stand
- Wardrobe and linen closet
- Walk-in closet
- Recessed LED lights
- Retractable shower door
- Towel rack, ring and paper holder
- Single bowl bathroom sink
- Toilet
- Shower
- Power roof vent in bathroom
- Metal grab handle
- Fresh water tank
- 12 volt demand water pump
- City water hook up
- 32 gallon black water tank
- 32 gallon gray water tank
- Sewer dump hose and storage compartment
- 2, 20 lb. propane tanks with automatic change over valve
- 6 gallon LP gas water heater, automatic recovery
- Water drains and water heater bypass for easy winterizing
- Furnace
- Heavy duty 60 amp 12 volt power converter, battery charger
- 12 volt charge line to truck
- 12 volt battery disconnect switch
- Deep cycle battery
- 30 amp marine style 25' power cord lifeline with 12 amp adapter
- 120 volt kitchen and bathroom receptacles, GFI protected
- LP gas leak detector

- All wiring checked and rechecked at 1,080 volts
- Smoke alarm and fire extinguisher
- Emergency exit windows
- Tempered safety glass with positive locks and screens
- Consumer protection seals
- Code approved in all 50 states

## TRAILER STANDARD FEATURES

- 2 5/16" Gooseneck hitch, adjustable
- Slant load
- 2 - 8 Horse
- 6'9" Wide
- 7' Tall
- 39" Wide stalls
- All aluminum construction
- All aluminum floors
- Choice of skin color top half, extruded aluminum sides lower half
- Rubber torsion axles
- 4 Wheel electric brakes with safety breakaway
- Rear rubber bumper
- LED clearance and tail lights
- Spare tire and wheel
- Air flow dividers with pads
- Floor mats in horse area
- Drop down feed door with sliding window per stall
- 2 Air gaps with Plexiglas on rump side
- SunCoated™ kick panels slant wall, rump wall and rear doors
- Double rear doors with Plexiglas
- Pop-up vent per horse stall
- Dome light in horse
- 1 Out and 2 inside tie rings per stall
- Collapsible rear tack with saddle rack, tack hooks and light
- Center access door from horse area to living quarter

## POPULAR OPTIONS

- Additional dome lights
- Load lights
- Aluminum face guard
- Electric motor assist on jack
- Hydraulic jack
- Rear ramp - Awning - Hayrack
- Rumpside window package per model (window per stall on rump side, window in load side rear door, side access door, and SunCoat™ on headside)

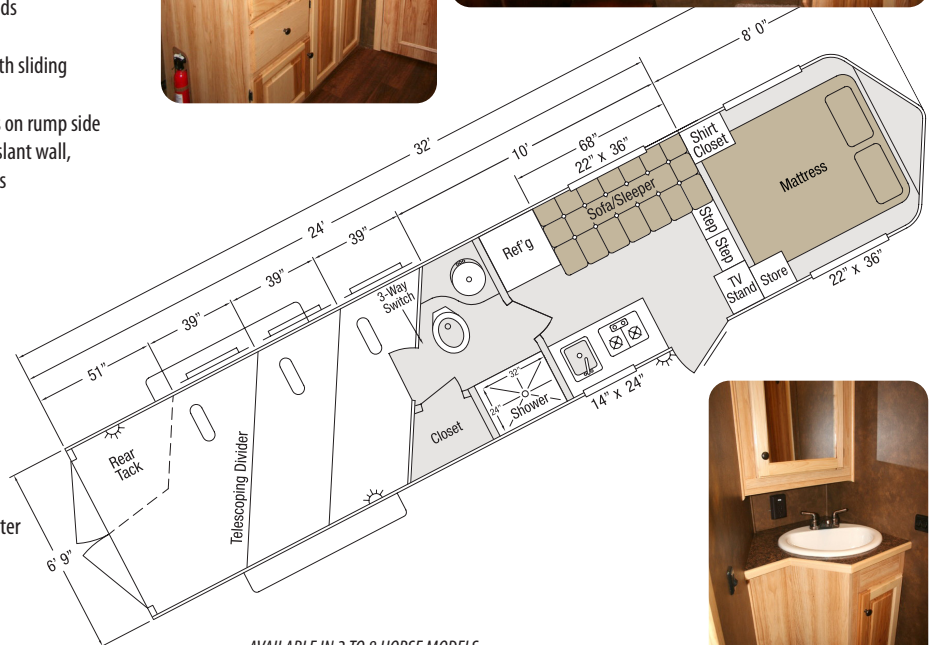

AVAILABLE IN 2 TO 8 HORSE MODELS.



All dimensions are approximate. Photos may show options. Due to constant product improvements, specifications, component parts, standard and optional equipment are subject to change without notice or obligation. Refer to standard and special features for specifics. See your dealer for warranty details. 2021 © Sundowner Trailers, Inc. (8.16.21)

SUNDOWNER TRAILERS, INC.

9805 OK Highway 48 South • Coleman, Oklahoma 73432-8523

800-438-4294 • sundownertrailer.com